



The Timken Company

4500 Mt Pleasant St. NW

N. Canton, OH 44720

Phone: (234) 262-3000

E-Mail: CustomerCAD@timken.com • Web site: www.timken.com

Part Number 7303 BTN1, Timken® Single Row Angular Contact Ball Bearings (7200, 7300)

Timken® angular contact ball bearings are designed for combination radial and axial loading. Single-row bearings have high thrust capacity in one direction. Some single-row bearings are specifically designed for duplex mounting in sets for maximum performance.

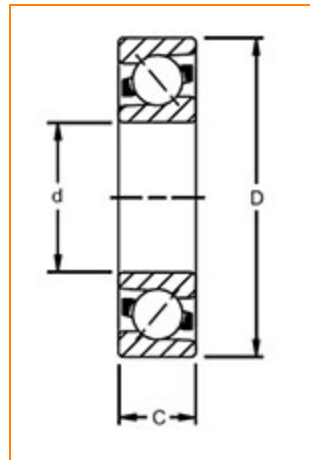

[Dimensions](#) | [Basic Load Ratings](#) | [Factors](#) | [Specifications](#) | [Abutment and Fillet Dimensions](#)

Dimensions

d - Bore	17.00 mm 0.6693 in
D - Outer Diameter	47.00 mm 1.8504 in
Bearing Width	14.00 mm 0.5512 in
Contact Angle	40 °

Basic Load Ratings

C0 - Static Radial Rating	8300 N 1866 lbf
----------------------------------	--------------------



14000 N

C1 ISO - Dynamic Radial Rating	10000 N 3596 lbf
---------------------------------------	---------------------

Factors

Limiting Speed (Grease)	15000 rpm
--------------------------------	-----------

Limiting Speed (Oil)	20000 rpm
-----------------------------	-----------

Specifications

Ball Type	STEEL
------------------	-------

Cage Type	Molded
------------------	--------

Cage Material	Polyamide
----------------------	-----------

Bearing Weight	0.11 Kg 0.243 lb
-----------------------	---------------------

Design Units	METRIC
---------------------	--------

R - Inner Ring "Touch" Radius	0.6
--------------------------------------	-----

r - Outer Ring "Touch" Radius	0.6
--------------------------------------	-----

Features	Open
-----------------	------

Abutment and Fillet Dimensions

R - Inner Ring "To Clear" Radius¹	0.60 mm 0.024 in
---	---------------------

r - Outer Ring "To Clear" Radius²	0.60 mm 0.024 in
---	---------------------

da - Inner Ring Backing Diameter	23.0 mm 0.906 in
---	---------------------

Da - Outer Ring Backing Diameter	41.0 mm 1.614 in
---	---------------------

- ¹ Maximum housing fillet radius that bearing corners will clear.
- ² Maximum shaft fillet radius that bearing corners will clear.

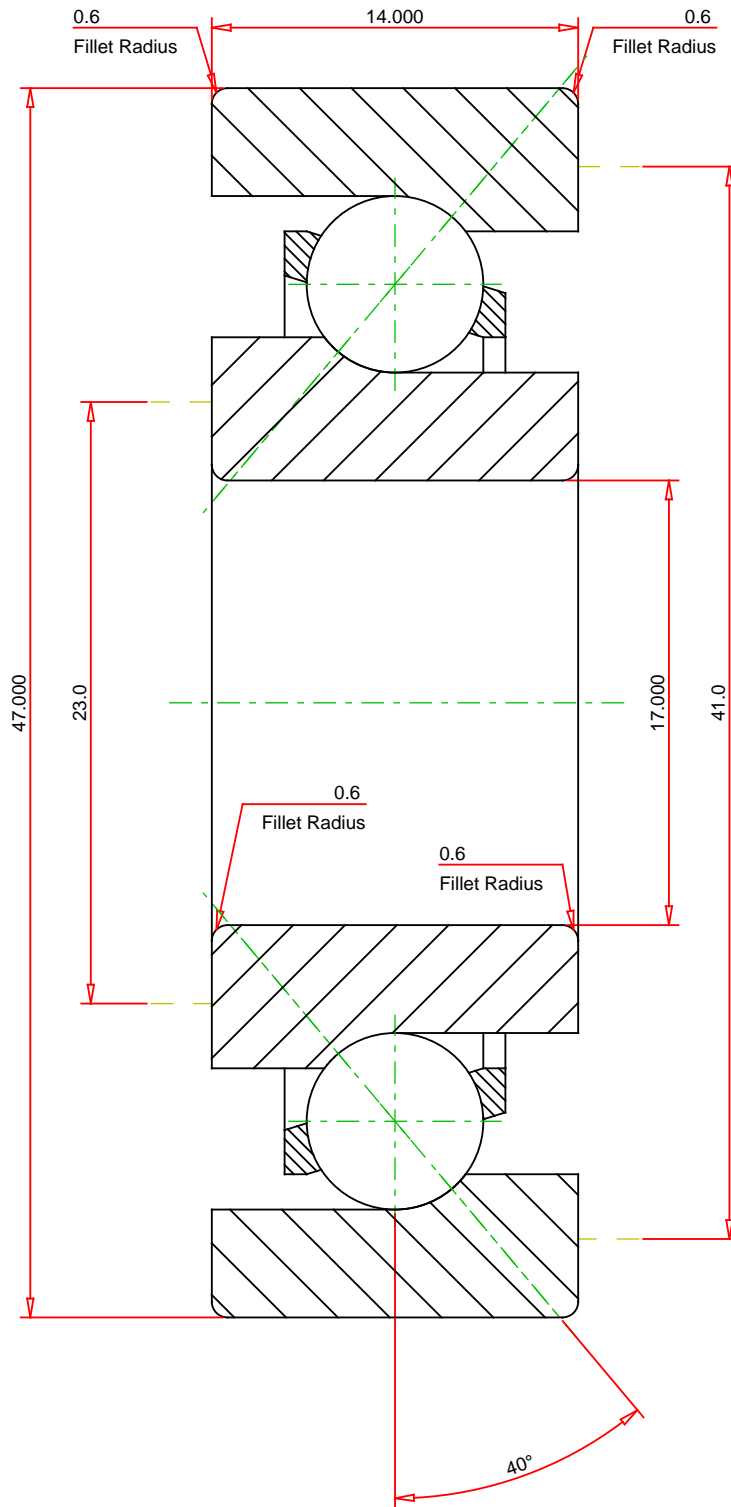

METRIC UNITS

Number of Balls Per Row	9
Bearing Weight	0.110 kg

TIMKEN®

THE TIMKEN COMPANY
NORTH CANTON, OHIO USA

7303 BTN1	
Timken® Single Row Angular Contact Ball Bearings (7200, 7300)	
Dynamic Radial Rating	16000 N
Static Radial Rating	8300 N

Every reasonable effort has been made to ensure the accuracy of the information contained in this writing, but no liability is accepted for errors, omissions or for any other reason.

FOR DISCUSSION ONLY